

Chains and Belt guides

Guides for
 880 TAB/881 TAB
 8811 TAB/ 879 TAB
 Page 02

Guides for
 882 TAB
 Page 03

Guides for
 1700
 Page 04

Guides for
 1701 TAB
 Page 05

Guides for
 1702
 Page 06

Guides for
 2600 C / 2600 O
 Page 07

Guides for
 2600 TAB C / 2600 TAB O
 Page 08

Custom made
 profiles for modular
 plastic belts
 Page 09

Single Profiles
 For Flex ONE
 Page 10-11

Guides for 880 TAB/881 TAB/ 8811 TAB/ 879 TAB

Chains Guides

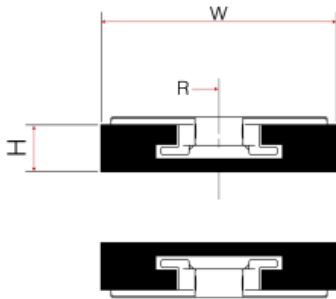

MATERIALS	PE500 and PE1000R, black
FEATURES	Radius in 90° angle Straight in and out of 50mm
ON REQUEST	Other materials and colours Other radius, in and out, section dimension and angles
NOTE	Profiles suitable also for 880 RIB and 880 RIB FLEX A set is composed of carry and return (1SET=2PCS)

K325 TAB (82,6 mm)	CURVE SET					
	W	H	T	R	ITEM CODE PE 500	ITEM CODE PE 1000R
1 track	100	25	-	500	346PE05R05001K0325880TK	346PE10R05001K0325880TK
1 track	100	25	-	610	346PE05R06101K0325880TK	346PE10R06101K0325880TK
K450 TAB (114,3 mm)	CURVE SET					
	W	H	T	R	ITEM CODE PE 500	ITEM CODE PE 1000R
1 track	125	25	-	500	346PE05R05001K0450880TK	346PE10R05001K0450880TK
1 track	125	25	-	610	346PE05R06101K0450880TK	346PE10R06101K0450880TK
K750 TAB (190,5 mm)	CURVE SET					
	W	H	T	R	ITEM CODE PE 500	ITEM CODE PE 1000R
1 track	200	25	-	610	346PE05R06101K0750880TK	346PE10R06101K0750880TK

STRAIGHT SET (2 mt/each bar)	
ITEM CODE PE 500	ITEM CODE PE 1000R
345PE05M21K0325880TK	345PE10M21K0325880TK
STRAIGHT SET (2 mt/each bar)	
ITEM CODE PE 500	ITEM CODE PE 1000R
345PE05M21K0450880TK	345PE10M21K0450880TK
STRAIGHT SET (2 mt/each bar)	
ITEM CODE PE 500	ITEM CODE PE 1000R
345PE05M21K0750880TK	345PE10M21K0750880TK

Guides for 882 TAB

Chains Guides

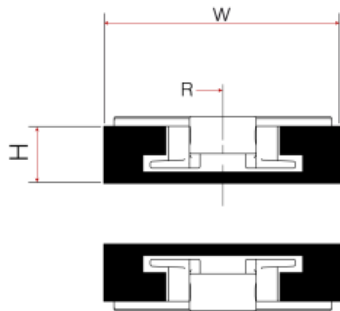

MATERIALS	PE500 and PE1000R, black
FEATURES	Radius in 90° angle Straight in and out of 50mm Radius for K1000 and over K1000 Multi track - the curve is splitted in 45° sections
ON REQUEST	Other materials and colours Other radius, in and out, section dimension and angles
NOTE	Profiles suitable also for 882 PRR TAB and 882 SC TAB A set is composed of carry and return (1SET=2PCS)

K450 TAB (114,3 mm)	CURVE SET						STRAIGHT SET (2 mt/each bar)	
	W	H	T	R	ITEM CODE PE 500	ITEM CODE PE 1000R	ITEM CODE PE 500	ITEM CODE PE 1000R
1 track	125	30	-	610	396PE05R06101K0450882TK	396PE10R06101K0450882TK	395PE05M21K0450882TK	395PE10M21K0450882TK
K750 TAB (190,5 mm)	CURVE SET						STRAIGHT SET (2 mt/each bar)	
	W	H	T	R	ITEM CODE PE 500	ITEM CODE PE 1000R	ITEM CODE PE 500	ITEM CODE PE 1000R
1 track	200	30	-	610	396PE05R06101K0750882TK	396PE10R06101K0750882TK	395PE05M21K0750882TK	395PE10M21K0750882TK
K71000 TAB (254 mm)	CURVE SET						STRAIGHT SET (2 mt/each bar)	
	W	H	T	R	ITEM CODE PE 500	ITEM CODE PE 1000R	ITEM CODE PE 500	ITEM CODE PE 1000R
1 track	270	30	-	610	396PE05R06101K1000882TK	396PE10R06101K1000882TK	395PE05M21K1000882TK	395PE10M21K1000882TK
K71200 TAB (304,8mm)	CURVE SET						STRAIGHT SET (2 mt/each bar)	
	W	H	T	R	ITEM CODE PE 500	ITEM CODE PE 1000R	ITEM CODE PE 500	ITEM CODE PE 1000R
1 track	320	30	-	610	396PE05R06101K1200882TK	396PE10R06101K1200882TK	395PE05M21K1200882TK	395PE10M21K1200882TK
K71500 TAB (381mm)	CURVE SET						STRAIGHT SET (2 mt/each bar)	
	W	H	T	R	ITEM CODE PE 500	ITEM CODE PE 1000R	ITEM CODE PE 500	ITEM CODE PE 1000R
1 track	400	30	-	700	396PE05R07001K1500882TK	396PE10R07001K1500882TK	395PE05M21K1500882TK	395PE10M21K1500882TK
K71600 TAB (406,4mm)	CURVE SET						STRAIGHT SET (2 mt/each bar)	
	W	H	T	R	ITEM CODE PE 500	ITEM CODE PE 1000R	ITEM CODE PE 500	ITEM CODE PE 1000R
1 track	425	30	-	700	396PE05R07001K1600882TK	396PE10R07001K1600882TK	395PE05M21K1600882TK	395PE10M21K1600882TK

Guides for 1700

Chains Guides

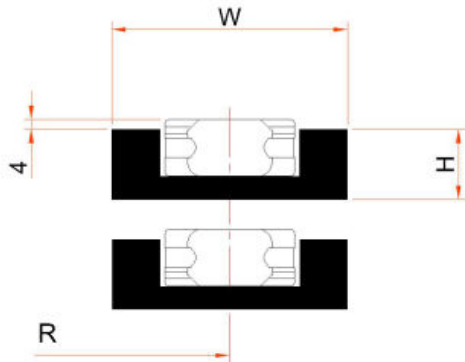

Double track example

MATERIALS	PE500 and PE1000, black
FEATURES	Radius in 90° angle Straight in and out of 50mm
ON REQUEST	Other materials and colours Other radius, in and out, section dimension and angles
NOTE	A set is composed of carry and return (1SET=2PCS)

CURVE SET							STRAIGHT SET (2 mt/each bar)	
Type	Chain width	Radius R	Width W	Thickness H	ITEM CODE PE 500	ITEM CODE PE 1000R	ITEM CODE PE 500	ITEM CODE PE 1000R
1702	53.3	400	100	25	316PE05R04001K02101702K	316PE10R04001K02101702K	315PE05M21K02101702K	315PE10M21K02101702K
1702	53.3	610	100	25	316PE05R06101K02101702K	316PE10R06101K02101702K		
1702	53.3	800	100	25	316PE05R08001K02101702K	316PE10R08001K02101702K		

Guides for 1701 TAB

Chains Guides

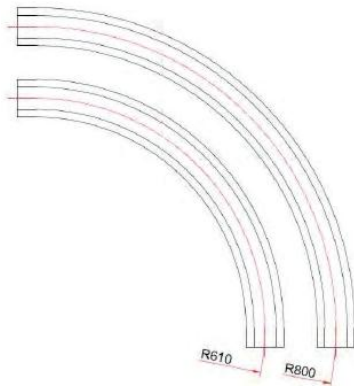
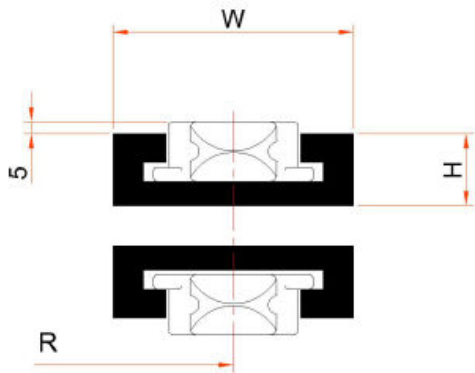

Double track example

MATERIALS	PE500 and PE1000, black
FEATURES	Radius in 90° angle Straight in and out of 50mm
ON REQUEST	Other materials and colours Other radius, in and out, section dimension and angles
NOTE	A set is composed of carry and return (1SET=2PCS)

CURVESET						STRAIGHT SET (2 m/each bar)		
Type	Chain width	Radius R	Width W	Thickness H	ITEM CODE PE 500	ITEM CODE PE 1000R	ITEM CODE PE 500	ITEM CODE PE 1000R
1701 TAB	53,3	400	100	30	316PE05R04001K02101701TK	316PE10R04001K02101701TK	315PE05M21K02101701TK	315PE10M21K02101701TK
1701 TAB	53,3	610	100	30	316PE05R06101K02101701TK	316PE10R06101K02101701TK		
1701 TAB	53,3	800	100	30	316PE05R08001K02101701TK	316PE10R08001K02101701TK		

Guides for 1702

Chains Guides

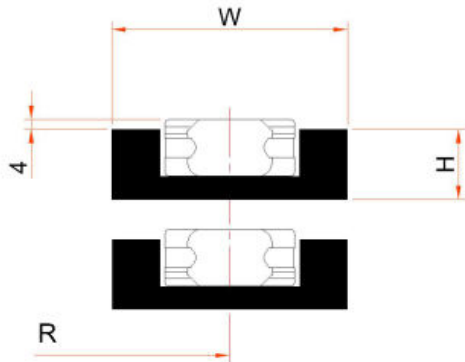

MATERIALS	PE500 and PE1000, black
FEATURES	Radius in 90° angle Straight in and out of 50mm
ON REQUEST	Other materials and colours Other radius, in and out, section dimension and angles
NOTE	A set is composed of carry and return (1SET=2PCS)

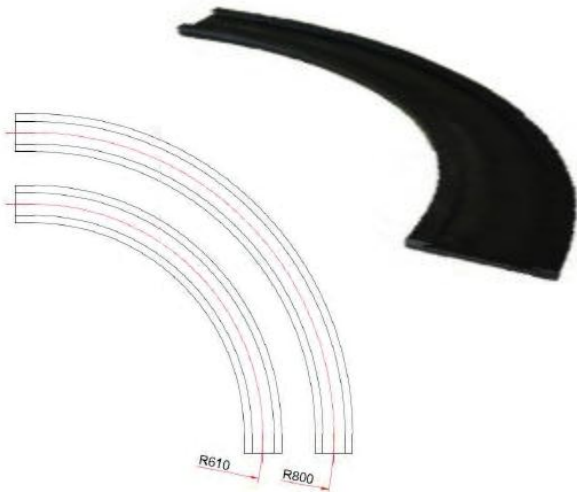

Double track example

CURVESET							STRAIGHT SET (2 m/each bar)	
Type	Chain width	Radius R	Width W	Thickness H	ITEM CODE PE 500	ITEM CODE PE 1000R	ITEM CODE PE 500	ITEM CODE PE 1000R
1701 TAB	53,3	400	100	30	316PE05R04001K02101701TK	316PE10R04001K02101701TK	315PE05M21K02101701TK	315PE10M21K02101701TK
1701 TAB	53,3	610	100	30	316PE05R06101K02101701TK	316PE10R06101K02101701TK		
1701 TAB	53,3	800	100	30	316PE05R08001K02101701TK	316PE10R08001K02101701TK		

Guides for 2600 C / 2600 O

Chains Guides

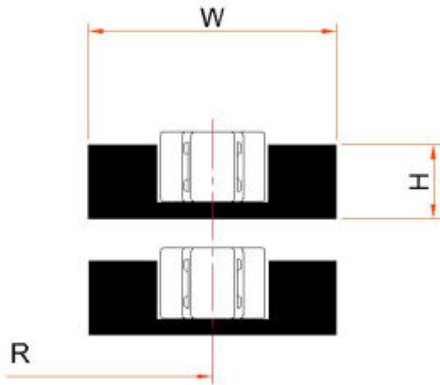

MATERIALS	PE500 and PE1000, black
FEATURES	Radius in 90° angle Straight in and out of 50mm
ON REQUEST	Other materials and colours Other radius, in and out, section dimension and angles
NOTE	A set is composed of carry and return (1SET=2PCS)

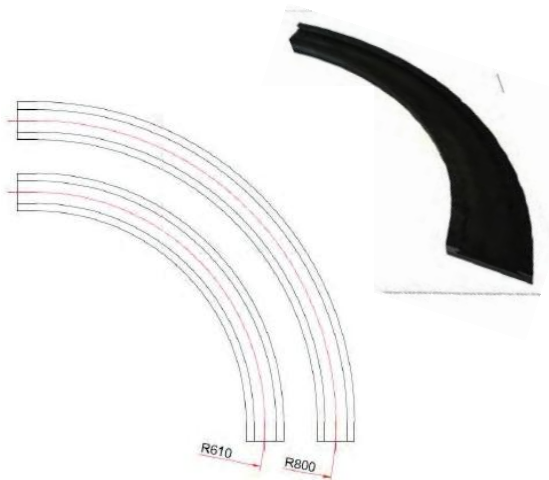

Double track example

CURVE SET							STRAIGHT SET (2 mt/each bar)	
Type	Chain width	Radius R	Width W	Thickness H	ITEM CODE PE 500	ITEM CODE PE 1000R	ITEM CODE PE 500	ITEM CODE PE 1000R
2600	42	610	100	30	366PE05R06101K01652600K	366PE10R06101K01652600K	365PE05M21K01652600CK	365PE10M21K01652600CK
2600	42	800	100	30	366PE05R08001K01652600K	366PE10R08001K01652600K		

Guides for 2600 TAB C / 2600 TAB O

Chains Guides

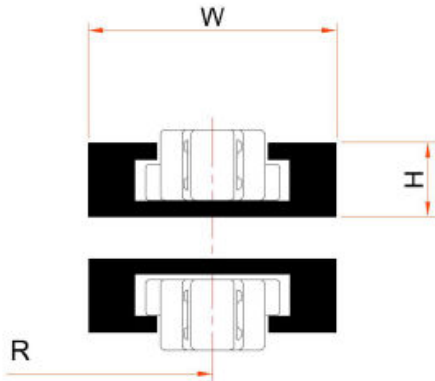

MATERIALS	PE500 and PE1000, black
FEATURES	Radius in 90° angle Straight in and out of 50mm
ON REQUEST	Other materials and colours Other radius, in and out, section dimension and angles
NOTE	A set is composed of carry and return (1SET=2PCS)

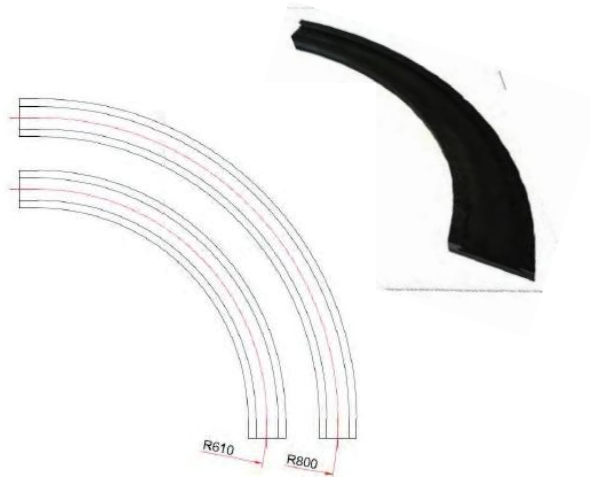

Double track example

CURVESET					STRAIGHT SET (2 mt/each bar)			
Type	Chain width	Radius R	Width W	Thickness H	ITEM CODE PE 500	ITEM CODE PE 1000R	ITEM CODE PE 500	ITEM CODE PE 1000R
2600 TAB	42	610	100	30	366PE05R06101K01652600TK	366PE10R06101K01652600TK	365PE05M21K01652600TK	365PE10M21K01652600TK
2600 TAB	42	800	100	30	366PE05R08001K01652600TK	366PE10R08001K01652600TK		

Custom-made profiles for modular plastic belts

Belt guides

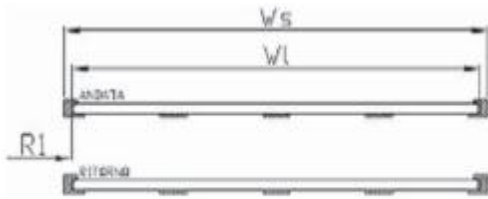

Ws: _____

Wl: _____

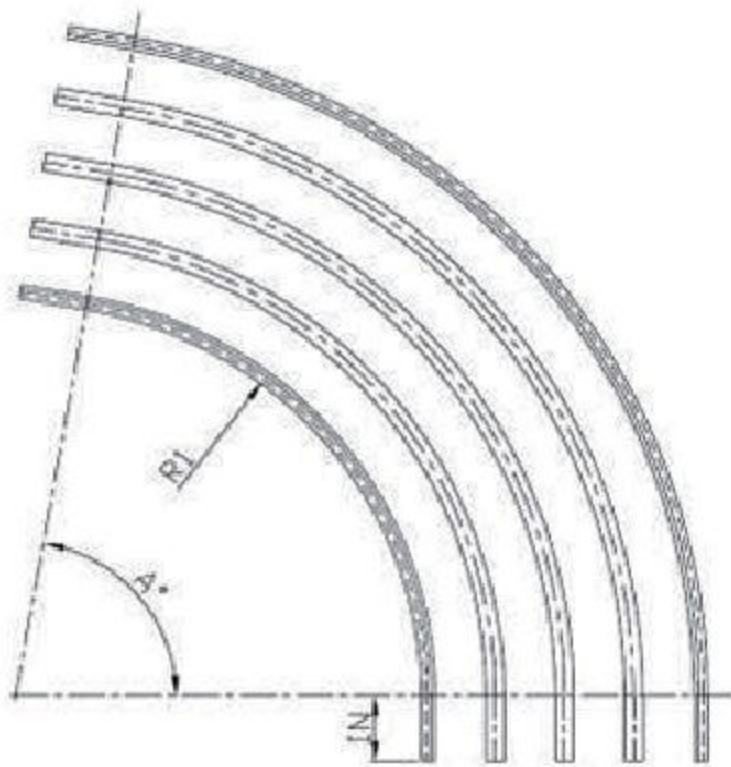

Speed (Mt/min): _____

Weight (kg/Mt): _____

Rm1(mm): _____ A°: _____

IN(mm): _____

OUT(mm): _____

Configuration: _____

Single profiles for Flex ONE

Belt Guides

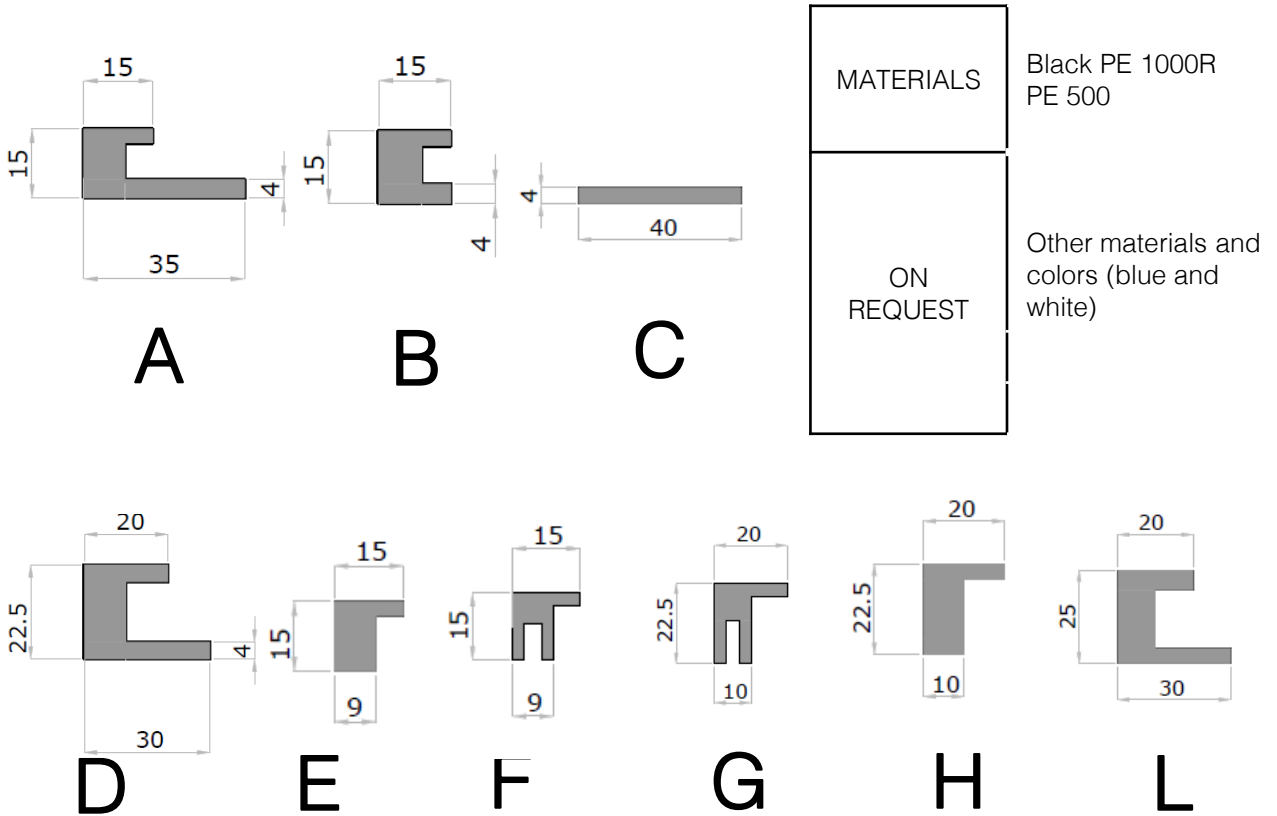

SINGLE PROFILES		
ID NUMBER	ITEM CODE 2mt/each	ITEM CODE 3mt/each
A	93ITAPE05M2AK	93ITAPE05M3AK
B	93ITAPE05M2BK	93ITAPE05M3BK
C	93ITAPE10M2CK	93ITAPE10M3CK
D	93ITAPE10M2DK	93ITAPE10M3DK
E	93ITAPE10M2EK	93ITAPE10M3EK
F	93ITAPE10M2FK	93ITAPE10M3FK
G	93ITAPE10M2GK	93ITAPE10M3GK
H	93ITAPE10M2HK	93ITAPE10M3HK
L	93ITAPE10M2LK	93ITAPE10M3LK

*Code with suffix "K" are in black color – ex. 826PE10R0975OEO2400SOK= black
 Code with suffix "W" are in white color – ex. 826PE10R0975OEO2400SOW= white
 Blue Color in Blue Line Section

Single profiles for Flex ONE

Belt Guides

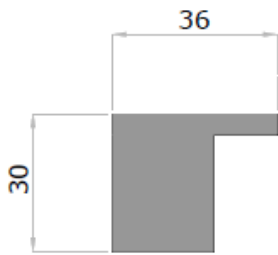

M

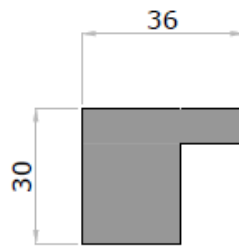

N

MATERIALS
ON REQUEST

Black PE 1000R – PE 500

Other materials and colours (blue and white)

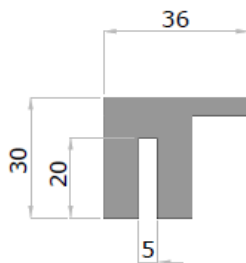

O

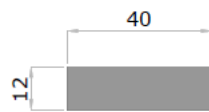

P

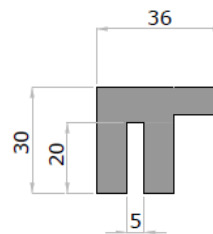

Q

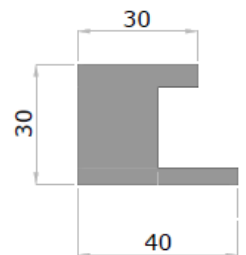

R

SINGLE PROFILES	
ID NUMBER	ITEM CODE 2mt/each
M	93ITAPE10M2-OEO-SOK
N	93ITAPE10M2-EOO-SOK
O	93ITAPE10M2-OEO-SLK
P	93ITAPE10M2K40X12
Q	93ITAPE10M2-EOO-SLK
R	93ITAPE10M2-EWER-SOK

*Code with suffix "K" are in black color – ex. 826PE10R0975OEO2400SOK= black
 Code with suffix "W" are in white color – ex. 826PE10R0975OEO2400SOW= white
 Blue Color in Blue Line Section