

Slat Top Plastic Chain

Series **uni 879** Type -

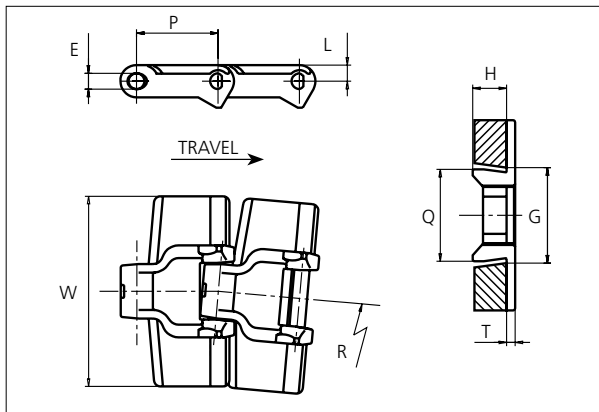

Slat Top Plastic Chain
 Side flexing chain
 Pitch: 38.1 mm (1.50 in)
 Backflex radius: 75 mm (3 in)
 Permissible tensile strength:
 POM material: 2250 N (506 lbf)

 Delivery: 3.048 m (10 ft)
 No. of links/box: 80

NON STANDARD

| E | | G* | | G** | | H | | J | | K | | L | | P | | Q | | T | |
|-----|------|------|------|------|------|------|------|------|------|------|------|-----|------|------|------|------|------|-----|------|
| mm | in | mm | in | mm | in | mm | in | mm | in | mm | in | mm | in | mm | in | mm | in | mm | in |
| 7.1 | 0.28 | 41.3 | 1.63 | 46.6 | 1.83 | 15.9 | 0.63 | 61.5 | 2.42 | 11.9 | 0.47 | 8.5 | 0.33 | 38.1 | 1.50 | 43.1 | 1.70 | 5.0 | 0.20 |

*Curve, ** Straight

All dimensions are for chains in POM material.

| | Width (W) | | Recommended material & color | Recommended pin material | Weight | | Min. radius (R) | | |
|-------------|-----------|------|--|---|--------------|-------|-----------------|-----|-------|
| | mm | in | | | kg/m | lb/ft | mm | in | |
| K250 | 63.5 | 2.50 | POM-D W POM-LF BR | POM-D G POM-SLF DG | SS304 | 1.0 | 0.67 | 400 | 15.75 |
| K325 | 82.6 | 3.25 | POM-D W POM-LF BR | POM-D G POM-SLF DG | SS304 | 1.0 | 0.67 | 400 | 15.75 |
| K450 | 114.3 | 4.50 | POM-D W POM-LF BR | POM-D G POM-SLF DG | SS304 | 1.3 | 0.87 | 400 | 15.75 |

Other non standard material and color: See uni Material and Color Overview.

Other non standard pin material: See uni Material and Color Overview.

Accessories

Rubber Top

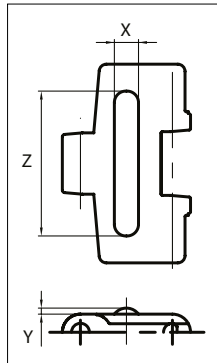

When ordering, please state the required distance between the Rubber Top.

Other Non Standard rubber profiles:
 See uni Rubber Profile Overview

| Width | Link material | Rubber material | Z | | X | | Y | |
|-------------|---|--|----|------|----|------|-----|------|
| | | | mm | in | mm | in | mm | in |
| K325 | POM-LF BR | 05 I | 60 | 2.36 | 10 | 0.39 | 2.5 | 0.10 |
| K450 | POM-LF BR | 05 I | 90 | 3.54 | 10 | 0.39 | 2.5 | 0.10 |

PITCH 38.1 MM/1.50 IN

Any questions? Please contact us.

Sprocket

| No of teeth | Pitch diameter | | Overall-diameter | | Min. ø bore | | Max. ø bore | | Hub-diameter | | A-dimension | | B-dimension | | Molded PA66 LG | Molded Cast Iron | Machined PA66 |
|-------------|----------------|------|------------------|------|-------------|------|-------------|------|--------------|------|-------------|------|-------------|------|----------------|------------------|---------------|
| | mm | in | mm | in | mm | in | mm | in | mm | in | mm | in | mm | in | | | |
| Z9 | 111.4 | 4.39 | 109.7 | 4.32 | 20.0 | 0.80 | 40.0 | 1.60 | 70.0 | 2.76 | 55.9 | 2.20 | 63.2 | 2.49 | x | x | |
| Z10 | 123.3 | 4.85 | 122.3 | 4.81 | 20.0 | 0.80 | 40.0 | 1.60 | 70.0 | 2.76 | 62.2 | 2.45 | 69.2 | 2.72 | x | x | |
| Z11 | 135.2 | 5.32 | 134.8 | 5.31 | 20.0 | 0.80 | 40.0 | 1.60 | 70.0 | 2.76 | 68.4 | 2.69 | 75.1 | 2.96 | x | x | |
| Z12 | 147.2 | 5.80 | 147.2 | 5.80 | 20.0 | 0.80 | 40.0 | 1.60 | 70.0 | 2.76 | 74.6 | 2.94 | 81.1 | 3.19 | x | x | |
| Z15 | 183.3 | 7.22 | 184.3 | 7.26 | 20.0 | 0.80 | 40.0 | 1.60 | 70.0 | 2.76 | 93.2 | 3.67 | 99.2 | 3.91 | x | x | |

Two part sprocket

| No of teeth | Pitch diameter | | Overall-diameter | | Min. ø bore | | Max. ø bore | | Hub-diameter | | A-dimension | | B-dimension | | Molded PA66 LG | Molded Cast Iron | Machined PA66 |
|-------------|----------------|------|------------------|------|-------------|------|-------------|------|--------------|------|-------------|------|-------------|------|----------------|------------------|---------------|
| | mm | in | mm | in | mm | in | mm | in | mm | in | mm | in | mm | in | | | |
| Z9 | 111.4 | 4.39 | 109.7 | 4.32 | 20.0 | 0.80 | 40.0 | 1.60 | 70.0 | 2.76 | 55.9 | 2.20 | 63.2 | 2.49 | x | | |
| Z10 | 123.3 | 4.85 | 122.3 | 4.81 | 20.0 | 0.80 | 40.0 | 1.60 | 70.0 | 2.76 | 62.2 | 2.45 | 69.2 | 2.72 | x | | |
| Z11 | 135.2 | 5.32 | 134.8 | 5.31 | 20.0 | 0.80 | 40.0 | 1.60 | 70.0 | 2.76 | 68.4 | 2.69 | 75.1 | 2.96 | x | | |
| Z12 | 147.2 | 5.80 | 147.2 | 5.80 | 20.0 | 0.80 | 40.0 | 1.60 | 70.0 | 2.76 | 74.6 | 2.94 | 81.1 | 3.19 | x | | |

Non standard material and color:
See uni Material and Color Overview.

Molded sprocket



Cast iron sprocket



Molded two part sprocket

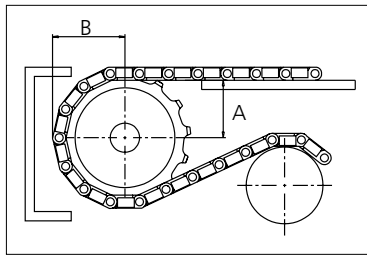

Please ensure that sufficient size shaft and keyway are chosen for corresponding load.

Other sprocket sizes are available upon request

Width of tooth: 15.8 mm/0.62 in

Width of sprocket: 42.3 mm/1.67 in

uni Retainer Rings: See uni Retainer Ring data sheet

uni Idler: See uni Idler data sheet

Any questions? Please contact us.

Morskate Aandrijvingen BV

Oosterveldsingel 47A
7558 PJ Hengelo (Ov)
The Netherlands

NL

T +31 (0)74 - 760 11 11
info@morskateaanrijvingen.nl
www.morskateaanrijvingen.nl

DE

T +49 692 - 222 34 95
info@morskateantriebstechnik.de
www.morskateantriebstechnik.de

EN

T +31 (0)74 - 760 11 11
info@morskatedrivetechnology.com
www.morskatedrivetechnology.com