

## Special Plastic Chain

Series **uni 882** Type **Tab PRR4**

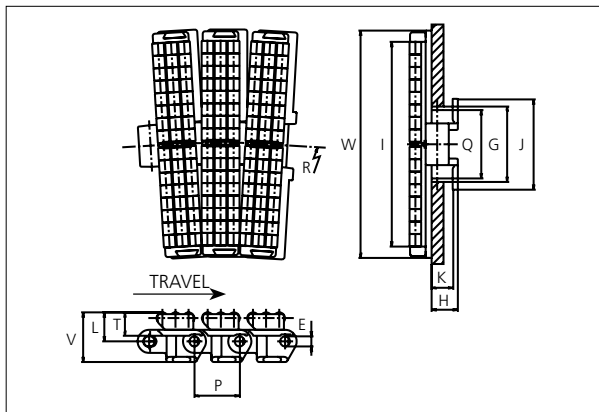

### Special Plastic Chain

Side flexing chain  
 Pitch: 38.1 mm (1.50 in)  
 Backflex radius: 101.0 mm (4.0 in)  
 Permissible tensile strength:  
 POM material: 4000 N (899 lbf)

Delivery: 3.048 m (10 ft)  
 No. of links/box: 80

Axle materials for  $\varnothing 4.0$  mm (0.16 in)  
 accumulation rollers: See  
 uni Material and Color Overview.

E		G		H		I (K325)		I (K400)		I (K750)		J		K		L		P		Q		T		V	
mm	in	mm	in	mm	in	mm	in	mm	in	mm	in	mm	in	mm	in	mm	in	mm	in	mm	in	mm	in	mm	in
8.7	0.34	59.5	2.34	22.2	0.87	79.3	3.12	98.3	3.87	174.5	6.87	76.2	3.00	17.5	0.69	23.5	0.93	38.1	1.50	57.2	2.25	19.0	0.75	41.2	1.62

All dimensions are for chains in POM material.

	Width (W)		Recommended base material & color	Recommended roller material & color	Recommended pin material	Weight		Min. radius (R)	
	mm	in				kg/m	lb/ft	mm	in
<b>K375</b>	95.3	3.75	POM-LF <b>BR</b>	POM-D <b>K</b>	<b>SS304</b>	3.4	2.30	610	24.02
<b>K450</b>	114.3	4.50	POM-LF <b>BR</b>	POM-D <b>K</b>	<b>SS304</b>	3.9	2.55	610	24.02
<b>K750</b>	190.5	7.50	POM-LF <b>BR</b>	POM-D <b>K</b>	<b>SS304</b>	5.7	3.83	610	24.02

Non standard material and color: See uni Material and Color Overview.  
 Non standart pin material: See uni Material and Color Overview.

NON STANDARD

SIDE FLEXING

PITCH 38.1 MM/1.50 IN

Any questions? Please contact us.

## Sprocket

No of teeth	Pitch diameter		Overall-diameter		Min. ø bore		Max. ø bore		Hub-diameter		A-dimension		B-dimension		Molded PA66 LG	Molded Cast Iron	Machined PA66
	mm	in	mm	in	mm	in	mm	in	mm	in	mm	in	mm	in			
<b>Z9</b>	111.4	4.39	112.7	4.44	20.0	0.79	45.0	1.77	60.0	2.36	57.1	2.25	65.4	2.57	x	x	
<b>Z10</b>	123.3	4.85	125.0	4.92	20.0	0.79	45.0	1.77	65.0	2.56	63.4	2.50	71.3	2.81	x	x	
<b>Z11</b>	135.2	5.32	137.4	5.41	20.0	0.79	50.0	1.97	73.5	2.89	69.6	2.74	77.3	3.04	x	x	
<b>Z12</b>	147.2	5.80	150.6	5.93	20.0	0.79	50.0	1.97	73.5	2.89	75.8	2.98	83.3	3.28	x	x	
<b>Z15</b>	183.3	7.22	186.9	7.36	20.0	0.79	50.0	1.97	120.0	4.72	94.3	3.71	101.3	3.99		x	x

## Two part sprocket

No of teeth	Pitch diameter		Overall-diameter		Min. ø bore		Max. ø bore		Hub-diameter		A-dimension		B-dimension		Molded PA66 LG	Molded Cast Iron	Machined PA66
	mm	in	mm	in	mm	in	mm	in	mm	in	mm	in	mm	in			
<b>Z9</b>	111.4	4.39	112.7	4.31	20.0	0.79	45.0	1.77	60.0	2.36	57.1	2.25	65.4	2.57	x		
<b>Z10</b>	123.3	4.85	125.0	4.81	20.0	0.79	45.0	1.77	65.0	2.56	63.4	2.50	71.3	2.81	x		
<b>Z11</b>	135.2	5.32	137.4	5.30	20.0	0.79	50.0	1.97	73.5	2.89	69.6	2.74	77.3	3.04	x		
<b>Z12</b>	147.2	5.80	150.6	5.79	20.0	0.79	50.0	1.97	73.5	2.89	75.8	2.98	83.3	3.28	x		

### Molded sprocket



### Cast iron sprocket



### Machined sprocket



### Molded two part sprocket



Non standard material and color:  
See uni Material and Color Overview.

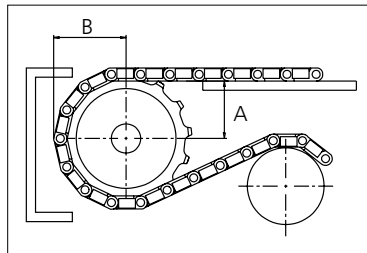

Please ensure that sufficient size shaft and keyway are chosen for corresponding load.

Other sprocket sizes are available upon request

Width of tooth: 22.20 mm/0.87 in

Width of sprocket: 42.3 mm/1.70 in

uni Retainer Rings: See uni Retainer Ring data sheet

Any questions? Please contact us.

#### Morskate Aandrijvingen BV

Oosterveldsingel 47A  
7558 PJ Hengelo (Ov)  
The Netherlands

NL

T +31 (0)74 - 760 11 11  
info@morskateaandrijvingen.nl  
www.morskateaandrijvingen.nl

DE

T +49 692 - 222 34 95  
info@morskateantriebstechnik.de  
www.morskateantriebstechnik.de

EN

T +31 (0)74 - 760 11 11  
info@morskatedrivetechnology.com  
www.morskatedrivetechnology.com